

Reliable since 1965...

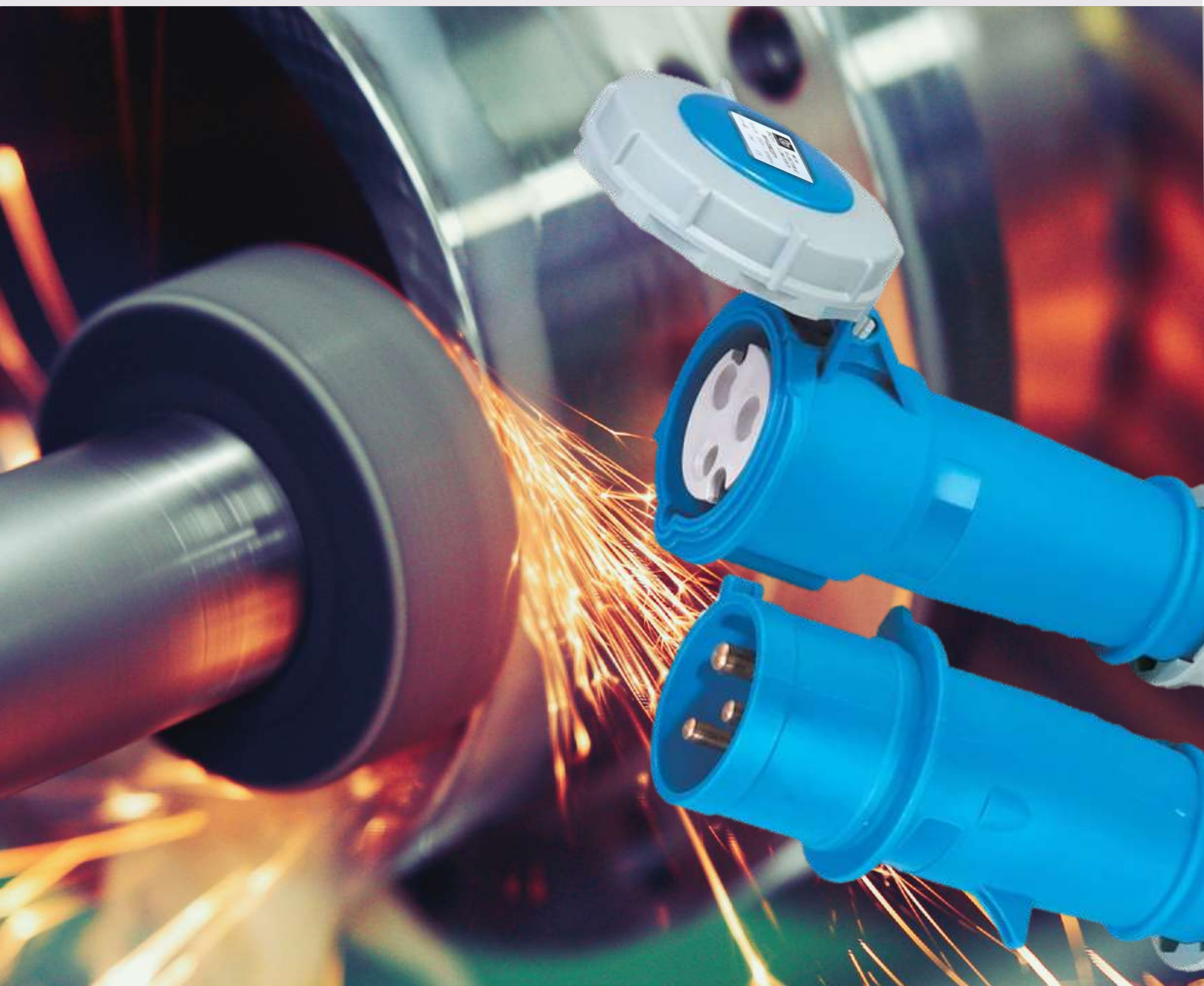

Polycarbonate Plug & Socket

BPX Series



**BCH
ELECTRIC
LIMITED**



BCH Electric Limited an ISO 9001:2015 & ISO 14001:2015, ISO 45001: 2018 company, is today one of the leading manufacturer of wide range of Industrial, IT Enclosures. It is wholly owned Indian company with a wide network of global business connections.

The company's strong focus on customer satisfaction is reflected in its wide product range, catering to the requirement of customers in the electric field. This includes Automation, Switchgears, Enclosures, Break and Crane control Products.

A strong Design & development team, state-of-the art manufacturing capabilities and strong emphasis on quality has helped the company achieve benchmarks for its products & services.

BCH Electric, as always, remains committed to customer satisfaction and loyalty and will continue to broaden its portfolio with more service and product to further strengthen its partnership with customers.

Our products have proven track of performance for critical applications in almost every customer segment - Steel, Power, Cement, Solar, Telecom, Railways, Mining, Oil & gas, Chemical, Sugar, water utilities, Automobiles, Agriculture, Crane & machinery OEMs etc.

Modern facilities at Faridabad & Rudrapur



Faridabad:
20/4, Mathura Road, Faridabad - 121 006 (Haryana)



Rdurapur:
64-68, Sector-7, IIE, Pant Nagar, Rudrapur,
Udham Singh Nagar - 263 153 (Uttarakhand)

BPX Series of Plug, Socket and Connector - Testing and Quality

Our product has passed various performance tests, including temperature-rise, mechanical life, material flame-retardant, surge voltage, vibration, high and low-temperature, Ingress protection, mechanical impact. All these aspects of our products far exceed the standard

Feature of Plug and Socket:

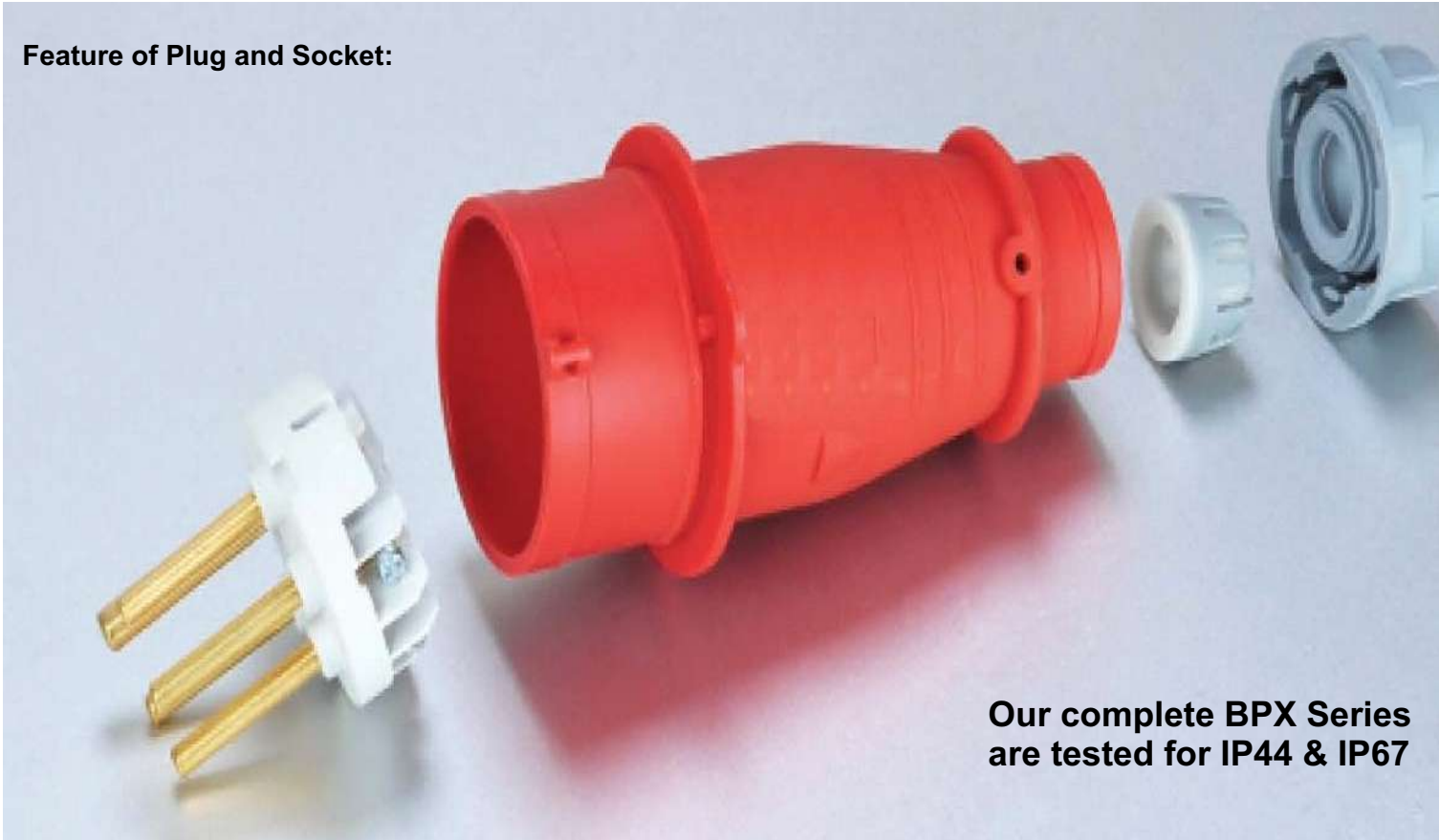

Our complete BPX Series are tested for IP44 & IP67



- Double screw type - terminal
- Large terminal size (1.5 Sq. mm to 35 Sq. mm).



- Excellent contact terminal for easy installation.



- Soft contact technology to reduce spark while insert or pullout.
- High electrical & mechanical life.



- The diameter of cable for 63A is 36.5mm and for 125A is 50mm



- Nickle plated contact.
- 125A contact use torsion spring contact to reduce friction force when insert and pullout the device.



- Cable entry hole from side or bottom.

Wide Application Areas :



SHOPPING MALL



MEDICAL EQUIPMENTS



METRO



AIRPORT



LAUNDRY MACHINE



RAILWAY



COMMERCIAL BUILDING

BPX Series of Plug, Socket and Connector - Testing and Quality

Our product has passed various performance tests, including temperature-rise, mechanical life, material flame-retardant, surge voltage, vibration, high and low-temperature, Ingress protection, mechanical impact. All these aspects of our products far exceed the standard

All Our BPX Series Plug, Sockets & Connectors are :

- | | |
|--|--|
| <ul style="list-style-type: none">• Compliant Standard• Resistant to Temperature• Ingress Protection (IP) Test• High Resistance to Heat, Fire & Tracking :<ul style="list-style-type: none">- Glow Wire Test- Dimensionally stable Test• Insulation Resistance• Di-electric Strength | <p>EN/IEC 60309-1 & 2</p> <p>-25 °C to +40°C</p> <p>IP44 & IP67</p> <p>Body Shell - 650° C ; Inner Core - 850° C</p> <p>100° C for 1 Hour</p> <p>500Vdc - 1min (> 5m Ohms)</p> <p>2000V~</p> |
|--|--|

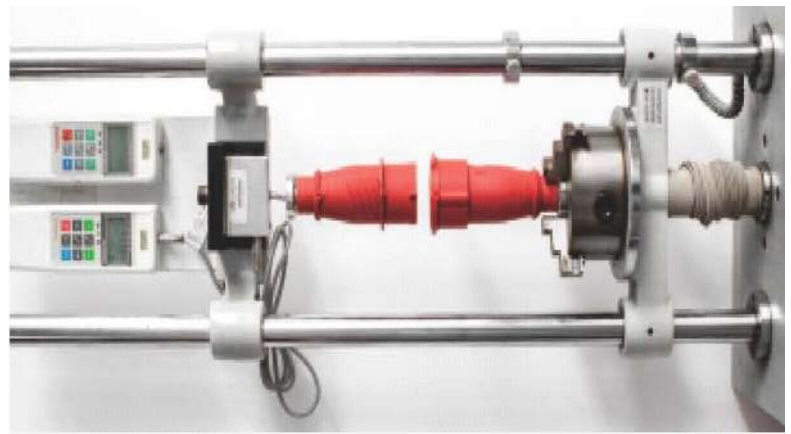
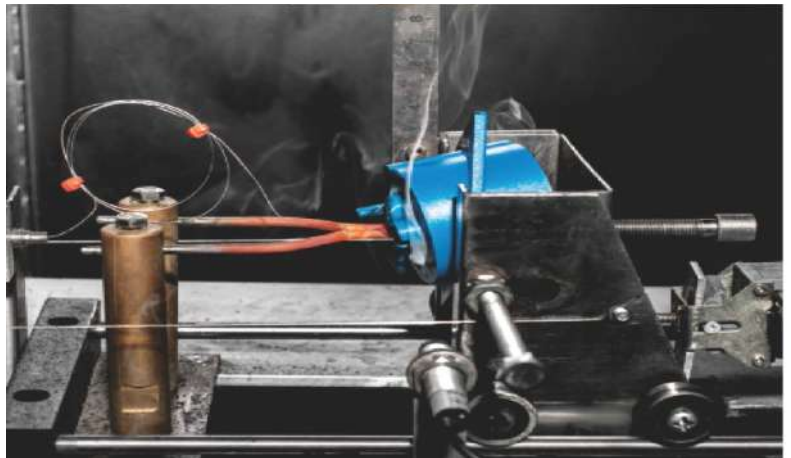

BPX Range of Plugs/Socket/Connector- 16A to 125A:

Conform to International standards IEC 60309-2

| Panel Mounted Straight Socket - IP44 | | | | | |
|--|-----|-------|------------|------------|--------------|
|  | Amp | Poles | 230V~ | 415V~ | Packing Unit |
| | 16 | 3 | | BPX1PSS341 | - |
| 4 | | | - | BPX1PSS442 | 10 |
| 5 | | | - | BPX1PSS542 | 10 |
| 32 | 3 | | BPX2PSS341 | - | 10 |
| | 4 | | - | BPX2PSS442 | 10 |
| | 5 | | - | BPX2PSS542 | 10 |
| 63 | 3 | | BPX3PSS341 | - | 5 |
| | 4 | | - | BPX3PSS442 | 5 |
| | 5 | | - | BPX3PSS542 | 5 |

| Panel Mounted Straight Socket - IP67 | | | | | |
|--|-----|-------|------------|------------|--------------|
|  | Amp | Poles | 230V~ | 415V~ | Packing Unit |
| | 16 | 3 | | BPX1PSS371 | - |
| 4 | | | - | BPX1PSS472 | 10 |
| 5 | | | - | BPX1PSS572 | 10 |
| 32 | 3 | | BPX2PSS371 | - | 10 |
| | 4 | | - | BPX2PSS472 | 10 |
| | 5 | | - | BPX2PSS572 | 10 |
| 63 | 3 | | BPX3PSS371 | - | 5 |
| | 4 | | - | BPX3PSS472 | 5 |
| | 5 | | - | BPX3PSS572 | 5 |
| 125A | 3 | | BPX4PSS371 | - | 5 |
| | 4 | | - | BPX4PSS472 | 5 |
| | 5 | | - | BPX4PSS572 | 5 |

| Panel Mounted Angled Socket - IP44 | | | | | |
|---|-----|-------|------------|------------|--------------|
|  | Amp | Poles | 230V~ | 415V~ | Packing Unit |
| | 16 | 3 | | BPX1PAS341 | - |
| 4 | | | - | BPX1PAS442 | 10 |
| 5 | | | - | BPX1PAS542 | 10 |
| 32 | 3 | | BPX2PAS341 | - | 10 |
| | 4 | | - | BPX2PAS442 | 10 |
| | 5 | | - | BPX2PAS542 | 10 |
| 63 | 3 | | BPX3PAS341 | - | 5 |
| | 4 | | - | BPX3PAS442 | 5 |
| | 5 | | - | BPX3PAS542 | 5 |

| Panel Mounted Angled Socket - IP67 | | | | | |
|---|-----|-------|------------|------------|--------------|
|  | Amp | Poles | 230V~ | 415V~ | Packing Unit |
| | 16 | 3 | | BPX1PAS371 | - |
| 4 | | | - | BPX1PAS472 | 10 |
| 5 | | | - | BPX1PAS572 | 10 |
| 32 | 3 | | BPX2PAS371 | - | 10 |
| | 4 | | - | BPX2PAS472 | 10 |
| | 5 | | - | BPX2PAS572 | 10 |
| 63 | 3 | | BPX3PAS371 | - | 5 |
| | 4 | | - | BPX3PAS472 | 5 |
| | 5 | | - | BPX3PAS572 | 5 |
| 125A | 3 | | BPX4PAS371 | - | 5 |
| | 4 | | - | BPX4PAS472 | 5 |
| | 5 | | - | BPX4PAS572 | 5 |

| Surface Mounted Socket - IP44 | | | | | |
|--|-----|-------|-----------|-----------|--------------|
|  | Amp | Poles | 230V~ | 415V~ | Packing Unit |
| | 16 | 3 | | BPX1WS341 | - |
| 4 | | | - | BPX1WS442 | 8 |
| 5 | | | - | BPX1WS542 | 10 |
| 32 | 3 | | BPX2WS341 | - | 10 |
| | 4 | | - | BPX2WS442 | 10 |
| | 5 | | - | BPX2WS542 | 10 |
| 63 | 3 | | BPX3WS341 | - | 3 |
| | 4 | | - | BPX3WS442 | 3 |
| | 5 | | - | BPX3WS542 | 3 |

| Surface Mounted Socket - IP67 | | | | | |
|--|-----|-------|-----------|-----------|--------------|
|  | Amp | Poles | 230V~ | 415V~ | Packing Unit |
| | 16 | 3 | | BPX1WS371 | - |
| 4 | | | - | BPX1WS472 | 10 |
| 5 | | | - | BPX1WS572 | 10 |
| 32 | 3 | | BPX2WS371 | - | 10 |
| | 4 | | - | BPX2WS472 | 10 |
| | 5 | | - | BPX2WS572 | 10 |
| 63 | 3 | | BPX3WS371 | - | 3 |
| | 4 | | - | BPX3WS472 | 3 |
| | 5 | | - | BPX3WS572 | 3 |
| 125A | 3 | | BPX4WS371 | - | 1 |
| | 4 | | - | BPX4WS472 | 1 |
| | 5 | | - | BPX4WS572 | 1 |

| Standard Connector - IP44 | | | | | |
|--|-----|-------|-----------|-----------|--------------|
|  | Amp | Poles | 230V~ | 415V~ | Packing Unit |
| | 16 | 3 | | BPX1SC341 | - |
| 4 | | | - | BPX1SC442 | 10 |
| 5 | | | - | BPX1SC542 | 10 |
| 32 | 3 | | BPX2SC341 | - | 10 |
| | 4 | | - | BPX2SC442 | 10 |
| | 5 | | - | BPX2SC542 | 10 |
| 63 | 3 | | BPX3SC341 | - | 5 |
| | 4 | | - | BPX3SC442 | 5 |
| | 5 | | - | BPX3SC542 | 5 |

| Standard Connector- IP67 | | | | | |
|--|-----|-------|-----------|-----------|--------------|
|  | Amp | Poles | 230V~ | 415V~ | Packing Unit |
| | 16 | 3 | | BPX1SC371 | - |
| 4 | | | - | BPX1SC472 | 10 |
| 5 | | | - | BPX1SC572 | 10 |
| 32 | 3 | | BPX2SC371 | - | 10 |
| | 4 | | - | BPX2SC472 | 10 |
| | 5 | | - | BPX2SC572 | 10 |
| 63 | 3 | | BPX3SC371 | - | 5 |
| | 4 | | - | BPX3SC472 | 5 |
| | 5 | | - | BPX3SC572 | 5 |
| 125A | 3 | | BPX4SC371 | - | 1 |
| | 4 | | - | BPX4SC472 | 1 |
| | 5 | | - | BPX4SC572 | 1 |

BPX Range of Plugs/Socket/Connector- 16A to 125A:

Conform to International standards IEC 60309-2

| Standard Plug - IP44 | | | | | |
|--|-----|-------|-----------|-----------|--------------|
|  | Amp | Poles | 230V~ | 415V~ | Packing Unit |
| | 16 | 3 | | BPX1SP341 | - |
| 4 | | | - | BPX1SP442 | 10 |
| 5 | | | - | BPX1SP542 | 10 |
| 32 | 3 | | BPX2SP341 | - | 10 |
| | 4 | | - | BPX2SP442 | 10 |
| | 5 | | - | BPX2SP542 | 10 |
| 63 | 3 | | BPX3SP341 | - | 5 |
| | 4 | | - | BPX3SP442 | 5 |
| | 5 | | - | BPX3SP542 | 5 |
| - | | | | | |

| Standard Plug - IP67 | | | | | |
|--|-----|-------|-----------|-----------|--------------|
|  | Amp | Poles | 230V~ | 415V~ | Packing Unit |
| | 16 | 3 | | BPX1SP371 | - |
| 4 | | | - | BPX1SP472 | 10 |
| 5 | | | - | BPX1SP572 | 10 |
| 32 | 3 | | BPX2SP371 | - | 10 |
| | 4 | | - | BPX2SP472 | 10 |
| | 5 | | - | BPX2SP572 | 10 |
| 63 | 3 | | BPX3SP371 | - | 5 |
| | 4 | | - | BPX3SP472 | 5 |
| | 5 | | - | BPX3SP572 | 5 |
| 125A | 3 | | BPX4SP371 | - | 1 |
| | 4 | | - | BPX4SP472 | 1 |
| | 5 | | - | BPX4SP572 | 1 |

| Phase Inverter Plug - IP44 | | | | |
|--|-----|-------|------------|--------------|
|  | Amp | Poles | 415V~ | Packing Unit |
| | 16 | 5 | | BPX1PIP542 |
| 32 | 5 | | BPX2PIP542 | 10 |

| Phase Inverter Plug - IP67 | | | | |
|---|-----|-------|------------|--------------|
|  | Amp | Poles | 415V~ | Packing Unit |
| | 16 | 5 | | BPX1PIP572 |
| 32 | 5 | | BPX2PIP572 | 10 |

| Panel Mounted Plug - IP44 | | | | | |
|--|-----|-------|-----------|-----------|--------------|
|  | Amp | Poles | 230V~ | 415V~ | Packing Unit |
| | 16 | 3 | | BPX1PP341 | - |
| 4 | | | - | BPX1PP442 | 10 |
| 5 | | | - | BPX1PP542 | 10 |
| 32 | 3 | | BPX2PP341 | - | 10 |
| | 4 | | - | BPX2PP442 | 10 |
| | 5 | | - | BPX2PP542 | 10 |
| 63 | 3 | | BPX3PP341 | - | 5 |
| | 4 | | - | BPX3PP442 | 5 |
| | 5 | | - | BPX3PP542 | 5 |
| - | | | | | |

| Panel Mounted Plug - IP67 | | | | | |
|--|-----|-------|-----------|-----------|--------------|
|  | Amp | Poles | 230V~ | 415V~ | Packing Unit |
| | 16 | 3 | | BPX1PP371 | - |
| 4 | | | - | BPX1PP472 | 10 |
| 5 | | | - | BPX1PP572 | 10 |
| 32 | 3 | | BPX2PP371 | - | 10 |
| | 4 | | - | BPX2PP472 | 10 |
| | 5 | | - | BPX2PP572 | 10 |
| 63 | 3 | | BPX3PP371 | - | 5 |
| | 4 | | - | BPX3PP472 | 5 |
| | 5 | | - | BPX3PP572 | 5 |
| 125A | 3 | | BPX4PP371 | - | 5 |
| | 4 | | - | BPX4PP472 | 5 |
| | 5 | | - | BPX4PP572 | 5 |



| Surface Mounted Plug - IP44 | | | | | |
|--|-----|-------|-----------|-----------|--------------|
|  | Amp | Poles | 230V~ | 415V~ | Packing Unit |
| | 16 | 3 | | BPX1WP341 | - |
| 4 | | | - | BPX1WP442 | 8 |
| 5 | | | - | BPX1WP542 | 10 |
| 32 | 3 | | BPX2WP341 | - | 10 |
| | 4 | | - | BPX2WP442 | 10 |
| | 5 | | - | BPX2WP542 | 10 |
| 63 | 3 | | BPX3WP341 | - | 2 |
| | 4 | | - | BPX3WP442 | 2 |
| | 5 | | - | BPX3WP542 | 2 |
| - | | | | | |



| Surface Mounted Plug - IP67 | | | | | |
|--|-----|-------|-----------|-----------|--------------|
|  | Amp | Poles | 230V~ | 415V~ | Packing Unit |
| | 16 | 3 | | BPX1WP371 | - |
| 4 | | | - | BPX1WP472 | 10 |
| 5 | | | - | BPX1WP572 | 10 |
| 32 | 3 | | BPX2WP371 | - | 10 |
| | 4 | | - | BPX2WP472 | 10 |
| | 5 | | - | BPX2WP572 | 10 |
| 63 | 3 | | BPX3WP371 | - | 2 |
| | 4 | | - | BPX3WP472 | 2 |
| | 5 | | - | BPX3WP572 | 2 |
| - | | | | | |

BX Range of Socket Outlet with Switch and Mechanical Interlock



Conform to International standards IEC 60309-2

Socket Outlet with Switch and Mechanical Interlock

| Horizontal Type - IP44 | | | | | | Horizontal Type - IP67 | | | | | |
|---|-----|-------|-------|------------|--------------|--|-----|-------|-------|------------|--------------|
|  | Amp | Poles | 230V~ | 415V~ | Packing Unit |  | Amp | Poles | 230V~ | 415V~ | Packing Unit |
| | 16 | 3 | | BPX1MIH341 | - | | 4 | 16 | 3 | | BPX1MIH371 |
| | 4 | | - | BPX1MIH442 | 4 | | 4 | | - | BPX1MIH472 | 4 |
| | 5 | | - | BPX1MIH542 | 4 | | 5 | | - | BPX1MIH572 | 4 |

| Vertical Type - IP44 | | | | | | Vertical Type - IP67 | | | | | |
|--|-----|-------|------------|------------|--------------|---|-----|-------|------------|------------|--------------|
|  | Amp | Poles | 230V~ | 415V~ | Packing Unit |  | Amp | Poles | 230V~ | 415V~ | Packing Unit |
| | 16 | 3 | | BPX1MIV341 | - | | 1 | 16 | 3 | | BPX1MIV371 |
| | 4 | | - | BPX1MIV442 | 1 | | 4 | | - | BPX1MIV472 | 1 |
| | 5 | | - | BPX1MIV542 | 1 | | 5 | | - | BPX1MIV572 | 1 |
| 32 | 3 | | BPX2MIV341 | - | 1 | 32 | 3 | | BPX2MIV371 | - | 1 |
| | 4 | | - | BPX2MIV442 | 1 | | 4 | | - | BPX2MIV472 | 1 |
| | 5 | | - | BPX2MIV542 | 1 | | 5 | | - | BPX2MIV572 | 1 |
| 63 | 3 | | BPX3MIV341 | - | 1 | 63 | 3 | | BPX3MIV371 | - | 1 |
| | 4 | | - | BPX3MIV442 | 1 | | 4 | | - | BPX3MIV472 | 1 |
| | 5 | | - | BPX3MIV542 | 1 | | 5 | | - | BPX3MIV572 | 1 |
| | | | - | | | 125 | 3 | | BPX4MIV371 | - | 1 |
| | | | - | | | | 4 | | - | BPX4MIV472 | 1 |
| | | | - | | | | 5 | | - | BPX4MIV572 | 1 |

Socket Outlet with Duo Interlock and DIN Rail*

| Vertical Type - IP44 | | | | | | Vertical Type - IP67 | | | | | |
|---|-----|-------|------------|------------|--------------|--|-----|-------|------------|------------|--------------|
|  | Amp | Poles | 230V~ | 415V~ | Packing Unit |  | Amp | Poles | 230V~ | 415V~ | Packing Unit |
| | 16 | 3 | | BPX1MID341 | - | | 1 | 16 | 3 | | BPX1MID371 |
| | 4 | | - | BPX1MID442 | 1 | | 4 | | - | BPX1MID472 | 1 |
| | 5 | | - | BPX1MID542 | 1 | | 5 | | - | BPX1MID572 | 1 |
| 32 | 3 | | BPX2MID341 | - | 1 | 32 | 3 | | BPX2MID371 | - | 1 |
| | 4 | | - | BPX2MID442 | 1 | | 4 | | - | BPX2MID472 | 1 |
| | 5 | | - | BPX2MID542 | 1 | | 5 | | - | BPX2MID572 | 1 |
| 63 | 3 | | BPX3MID341 | - | 1 | 63 | 3 | | BPX3MID371 | - | 1 |
| | 4 | | - | BPX3MID442 | 1 | | 4 | | - | BPX3MID472 | 1 |
| | 5 | | - | BPX3MID542 | 1 | | 5 | | - | BPX3MID572 | 1 |
| | | | - | | | 125 | 3 | | BPX4MID371 | - | 1 |
| | | | - | | | | 4 | | - | BPX4MID472 | 1 |
| | | | - | | | | 5 | | - | BPX4MID572 | 1 |

*All the part codes are without MCB's

Product Dimension Details

| | 16A | | | 32A | | | 63A | | | 125A | | | |
|-----------------------------|-------------------|------------------|-------|--------------|--------------|-------|----------------|----------------|-------|-------|----------------|------|------|
| | Pole | 3P | 4P | 5P | 3P | 4P | 5P | 3P | 4P | 5P | 3P | 4P | 5P |
| Standard Plug IP44 | a | 137 | 142 | 144 | 173 | 173 | 177 | 238.9 | 238.9 | 238.9 | | | |
| | b | 110 | 119 | 121 | 144 | 144 | 148 | 179.4 | 179.4 | 179.4 | | | |
| | c | 43.5 | 49.5 | 56 | 57 | 57 | 63.3 | 69.1 | 69.1 | 69.1 | | | |
| | d | 38.5 | 43.8 | 50 | 51 | 51 | 56.5 | 63 | 63 | 63 | | | |
| | e | 17.5 | 21.5 | 28.5 | 25 | 25 | 30.5 | 36.5 | 36.5 | 36.5 | | | |
| | f | 47 | 52 | 60 | 62 | 62 | 68.7 | 75.3 | 75.3 | 75.3 | | | |
| | g | 58 | 66.7 | 75 | 80.7 | 80.7 | 89 | 100.1 | 100.1 | 100.1 | | | |
| | Terminal Capacity | 1.5 – 2.5 sq. mm | | | 4 – 6 sq. mm | | | 10 – 16 sq. mm | | | | | |
| Standard Plug IP67 | a | 140 | 142 | 144 | 173 | 173 | 177 | 238.9 | 238.9 | 238.9 | 286 | 286 | 286 |
| | b | 116 | 119 | 121 | 144 | 144 | 148 | 179.5 | 179.5 | 179.5 | 219 | 219 | 219 |
| | c | 24.7 | 26 | 27 | 32.5 | 32.5 | 32.6 | 51.1 | 51.1 | 51.1 | 57 | 57 | 57 |
| | d | 70.2 | 78 | 87 | 93.3 | 93.3 | 101 | 112.9 | 112.9 | 112.9 | 131 | 131 | 131 |
| | e | 38.5 | 43.8 | 50 | 51 | 51 | 56.5 | 63 | 63 | 63 | 75.1 | 75.1 | 75.1 |
| | f | 17.5 | 21.5 | 26.5 | 25 | 25 | 30.3 | 36.5 | 36.5 | 36.5 | 42.5 | 42.5 | 42.5 |
| | g | 47 | 52 | 60 | 62 | 62 | 68.7 | 75.3 | 75.3 | 75.3 | 87.2 | 87.2 | 87.2 |
| | Terminal Capacity | 1.5 – 2.5 sq. mm | | | 4 – 6 sq. mm | | | 10 – 16 sq. mm | | | 23 – 35 sq. mm | | |
| Standard Connector IP44 | a | 155 | 156.5 | 161.7 | 200 | 200 | 205 | 257 | 257 | 257 | | | |
| | b | 80.6 | 82.3 | 88 | 106.5 | 106.5 | 108.7 | 112.5 | 112.5 | 112.5 | | | |
| | c | 51.3 | 51.8 | 52.1 | 64.2 | 64.2 | 65 | 95 | 95 | 95 | | | |
| | d | 49.5 | 55.7 | 63 | 64.2 | 64.2 | 70.8 | 77.4 | 77.4 | 77.4 | | | |
| | e | 86 | 90 | 97 | 101.8 | 101.8 | 111 | 108 | 108 | 108 | | | |
| | f | 34.7 | 37 | 37 | 37 | 37 | 37 | 34 | 34 | 34 | | | |
| | g | 57 | 61.2 | 69 | 71.6 | 71.6 | 79.5 | 92 | 92 | 92 | | | |
| | Terminal Capacity | 1.5 – 2.5 sq. mm | | | 4 – 6 sq. mm | | | 10 – 16 sq. mm | | | | | |
| Standard Connector IP67 | a | 160 | 164 | 167 | 203 | 203 | 205.5 | 260 | 260 | 260 | 315 | 315 | 315 |
| | b | 54.7 | 55.5 | 56.3 | 67.5 | 67.5 | 68 | 104 | 104 | 104 | 116 | 116 | 116 |
| | c | 90 | 101 | 103 | 100 | 100 | 137.7 | 95 | 95 | 95 | 130 | 130 | 130 |
| | d | 49.5 | 55.7 | 63 | 64.2 | 64.2 | 70.8 | 77.4 | 77.4 | 77.4 | 89.5 | 89.5 | 89.5 |
| | e | 71.7 | 80.6 | 89 | 95.5 | 95.5 | 101.9 | 109 | 109 | 109 | 121 | 121 | 121 |
| | f | 79.7 | 85.7 | 93 | 98.3 | 98.3 | 104.9 | 112.5 | 112.5 | 112.5 | 125 | 125 | 125 |
| | g | 34.7 | 37 | 37 | 37 | 37 | 37 | 34 | 34 | 34 | 34.5 | 34.5 | 34.5 |
| | Terminal Capacity | 1.5 – 2.5 sq. mm | | | 4 – 6 sq. mm | | | 10 – 16 sq. mm | | | 23 – 35 sq. mm | | |
| Phase Inverter Plug IP44 | a | 137 | 142 | 144 | 173 | 173 | 177 | 238.9 | 238.9 | 238.9 | | | |
| | b | 110 | 119 | 121 | 144 | 144 | 148 | 179.4 | 179.4 | 179.4 | | | |
| | c | 43.5 | 49.5 | 56 | 57 | 57 | 63.3 | 69.1 | 69.1 | 69.1 | | | |
| | d | 38.5 | 43.8 | 50 | 51 | 51 | 56.5 | 63 | 63 | 63 | | | |
| | e | 17.5 | 21.5 | 28.5 | 25 | 25 | 30.5 | 36.5 | 36.5 | 36.5 | | | |
| | f | 47 | 52 | 60 | 62 | 62 | 68.7 | 75.3 | 75.3 | 75.3 | | | |
| | g | 58 | 66.7 | 75 | 80.7 | 80.7 | 89 | 100.1 | 100.1 | 100.1 | | | |
| | Terminal Capacity | 1.5 – 2.5 sq. mm | | | 4 – 6 sq. mm | | | 10 – 16 sq. mm | | | | | |
| Phase Inverter Plug IP67 | a | 140 | 142 | 144 | 173 | 173 | 177 | 238.9 | 238.9 | 238.9 | 286 | 286 | 286 |
| | b | 116 | 119 | 121 | 144 | 144 | 148 | 179.5 | 179.5 | 179.5 | 219 | 219 | 219 |
| | c | 24.7 | 26 | 27 | 32.5 | 32.5 | 32.6 | 51.1 | 51.1 | 51.1 | 57 | 57 | 57 |
| | d | 70.2 | 78 | 87 | 93.3 | 93.3 | 101 | 112.9 | 112.9 | 112.9 | 131 | 131 | 131 |
| | e | 38.5 | 43.8 | 50 | 51 | 51 | 56.5 | 63 | 63 | 63 | 75.1 | 75.1 | 75.1 |
| | f | 17.5 | 21.5 | 26.5 | 25 | 25 | 30.3 | 36.5 | 36.5 | 36.5 | 42.5 | 42.5 | 42.5 |
| | g | 47 | 52 | 60 | 62 | 62 | 68.7 | 75.3 | 75.3 | 75.3 | 87.2 | 87.2 | 87.2 |
| | Terminal Capacity | 1.5 – 2.5 sq. mm | | | 4 – 6 sq. mm | | | 10 – 16 sq. mm | | | 23 – 35 sq. mm | | |
| Panel Mounted Plug IP44 | a | 85.7 | 85.7 | 85.7 | 85.7 | 85.7 | 85.7 | 110 | 110 | 110 | | | |
| | b | 85.7 | 85.7 | 85.7 | 85.7 | 85.7 | 85.7 | 106 | 106 | 106 | | | |
| | c | 72 | 72 | 72 | 90 | 90 | 90 | 85 | 85 | 85 | | | |
| | d | 69.5 | 69.5 | 69.5 | 69.5 | 69.5 | 69.5 | 90 | 90 | 90 | | | |
| | e | 69.5 | 69.5 | 69.5 | 69.5 | 69.5 | 69.5 | 90 | 90 | 90 | | | |
| | f | 5.5 | 5.5 | 5.5 | 5.5 | 5.5 | 5.5 | 5.5 | 5.5 | 5.5 | | | |
| | g | 10 | 10 | 10 | 10 | 10 | 10 | 11 | 11 | 11 | | | |
| | g,1 | 2 | 2 | 2 | 2 | 2 | 2 | 2 | 2 | 2 | | | |
| l | 32 | 36 | 42 | 47 | 47 | 50 | 80 | 80 | 80 | | | | |
| Terminal Capacity | 1.5 – 2.5 sq. mm | | | 4 – 6 sq. mm | | | 10 – 16 sq. mm | | | | | | |

All dimensions are in mm

Product Dimension Details

| Amp Pole | 16A | | | 32A | | | 63A | | | 125A | | |
|-------------------|---------------------|-------|-------|---------------------|-------|-------|---------------------|-------|-------|---------------------|-----|-----|
| | 3P | 4P | 5P | 3P | 4P | 5P | 3P | 4P | 5P | 3P | 4P | 5P |
| a | 87.5 | 87.5 | 87.5 | 87.5 | 87.5 | 87.5 | 110 | 110 | 110 | 130 | 130 | 130 |
| b | 87.5 | 87.5 | 87.5 | 87.5 | 87.5 | 87.5 | 106 | 106 | 106 | 130 | 130 | 130 |
| c | 72 | 72 | 72 | 90 | 90 | 90 | 86 | 86 | 86 | 112 | 112 | 112 |
| d | 69.5 | 69.5 | 69.5 | 69.5 | 69.5 | 69.5 | 90 | 90 | 90 | 104 | 104 | 104 |
| e | 69.5 | 69.5 | 69.5 | 69.5 | 69.5 | 69.5 | 90 | 90 | 90 | 104 | 104 | 104 |
| f | 5.5 | 5.5 | 5.5 | 5.5 | 5.5 | 5.5 | 5.5 | 5.5 | 5.5 | 6.5 | 6.5 | 6.5 |
| g | 10 | 10 | 10 | 10 | 10 | 10 | 11 | 11 | 11 | 25 | 25 | 25 |
| g.1 | 2 | 2 | 2 | 2 | 2 | 2 | 2 | 2 | 2 | 2 | 2 | 2 |
| l | 32 | 36 | 42 | 47 | 47 | 50 | 80 | 80 | 80 | 95 | 95 | 95 |
| s | 71 | 79 | 89 | 94 | 94 | 102 | 113 | 113 | 113 | 131 | 131 | 131 |
| Terminal Capacity | 1.5 – 2.5 sq. mm | | | 4 – 6 sq. mm | | | 10 – 16 sq. mm | | | 23 – 35 sq. mm | | |
| a | 64.2 | 64.2 | 64.2 | 90.2 | 90.2 | 90.2 | 133.3 | 133.3 | 133.3 | | | |
| b | 77.5 | 77.5 | 77.5 | 79 | 79 | 79 | 107.8 | 107.8 | 107.8 | | | |
| c | 88 | 88 | 88 | 98.5 | 98.5 | 98.5 | 136 | 136 | 136 | | | |
| d | 94.6 | 94.6 | 94.6 | 120.7 | 120.7 | 120.7 | 171.3 | 171.3 | 171.3 | | | |
| e | 114.9 | 122.6 | 129.9 | 145 | 145 | 151.8 | 180.1 | 180.1 | 180.1 | | | |
| f | 129.4 | 129.9 | 128.3 | 162.8 | 162.8 | 161.8 | 219.4 | 219.4 | 219.4 | | | |
| g | 5.5 | 5.5 | 5.5 | 5.5 | 5.5 | 5.5 | 6 | 6 | 6 | | | |
| h | 5 | 5 | 5 | 5 | 5 | 5 | 5 | 5 | 5 | | | |
| M | 25 | 25 | 25 | 32 | 32 | 32 | 40 | 40 | 40 | | | |
| M* | 1 x M25 Cable Entry | | | 1 x M32 Cable Entry | | | 1 x M40 Cable Entry | | | | | |
| Terminal Capacity | 1.5 – 2.5 sq. mm | | | 4 – 6 sq. mm | | | 10 – 16 sq. mm | | | | | |
| a | 64.2 | 64.2 | 64.2 | 90.2 | 90.2 | 90.2 | 133.3 | 133.3 | 133.3 | | | |
| b | 77.5 | 77.5 | 77.5 | 79 | 79 | 79 | 107.8 | 107.8 | 107.8 | | | |
| c | 88 | 88 | 88 | 98.5 | 98.5 | 98.5 | 136 | 136 | 136 | | | |
| d | 94.6 | 94.6 | 94.6 | 120.7 | 120.7 | 120.7 | 171.3 | 171.3 | 171.3 | | | |
| e | 116.5 | 105 | 134.4 | 148.4 | 148.4 | 155.4 | 180.1 | 180.1 | 180.1 | | | |
| f | 129.4 | 129.9 | 128.3 | 162.8 | 162.8 | 161.8 | 219.4 | 219.4 | 219.4 | | | |
| g | 5.5 | 5.5 | 5.5 | 5.5 | 5.5 | 5.5 | 6 | 6 | 6 | | | |
| h | 5 | 5 | 5 | 5 | 5 | 5 | 5 | 5 | 5 | | | |
| M | 25 | 25 | 25 | 32 | 32 | 32 | 40 | 40 | 40 | | | |
| M* | 1 x M25 Cable Entry | | | 1 x M32 Cable Entry | | | 1 x M40 Cable Entry | | | | | |
| Terminal Capacity | 1.5 – 2.5 sq. mm | | | 4 – 6 sq. mm | | | 10 – 16 sq. mm | | | | | |
| a | 87 | 100 | 100 | 128 | 128 | 128 | 171 | 171 | 171 | | | |
| b | 62 | 67 | 67 | 71 | 71 | 71 | 95 | 95 | 95 | | | |
| c | 110 | 125 | 131 | 147 | 147 | 152 | 165 | 165 | 165 | | | |
| d | 40 | - | - | 11 | 11 | 11 | 133 | 133 | 133 | | | |
| d1 | - | 11 | 11 | - | - | - | I-136 | I-136 | I-136 | | | |
| e | 50 | 59 | 59 | 68 | 68 | 68 | 108 | 108 | 108 | | | |
| f | 4.5 | 5 | 5 | 5.3 | 5.3 | 5.3 | 6 | 6 | 6 | | | |
| g | 4 | 4 | 4 | 4 | 4 | 4 | 5 | 5 | 5 | | | |
| h | 115 | 118 | 128 | 158 | 158 | 160 | 216 | 216 | 216 | | | |
| M | 20 | 20 | 20 | 32 | 32 | 32 | 40 | 40 | 40 | | | |
| M* | 1 x M25 Cable Entry | | | 1 x M32 Cable Entry | | | 1 x M40 Cable Entry | | | | | |
| Terminal Capacity | 1.5 – 2.5 sq. mm | | | 4 – 6 sq. mm | | | 10 – 16 sq. mm | | | | | |
| a | 95 | 95 | 95 | 120 | 120 | 120 | 171.3 | 171.3 | 171.3 | 260 | 260 | 260 |
| b | 89.5 | 89.5 | 89.5 | 100 | 100 | 100 | 136 | 136 | 136 | 160 | 160 | 160 |
| c | 117.5 | 125.5 | 133 | 145 | 145 | 152 | 169 | 169 | 169 | 199 | 199 | 199 |
| d | 65 | 65 | 65 | 91 | 91 | 91 | 134.5 | 134.5 | 134.5 | 240 | 240 | 240 |
| e | 77.5 | 77.5 | 77.5 | 79 | 79 | 79 | 108 | 108 | 108 | 140 | 140 | 140 |
| e1 | 101 | 101 | 101 | 112 | 112 | 112 | 157 | 157 | 157 | 140 | 140 | 140 |
| f | 5.5 | 5.5 | 5.5 | 5.5 | 5.5 | 5.5 | 6 | 6 | 6 | 8.1 | 8.1 | 8.1 |
| g | 5.2 | 5.2 | 5.2 | 5.5 | 5.5 | 5.5 | 5.5 | 5.5 | 5.5 | 8 | 8 | 8 |
| h | 132.5 | 134 | 135.5 | 162 | 162 | 164 | 218 | 218 | 218 | 305 | 305 | 305 |
| M | 25 | 25 | 25 | 32 | 32 | 32 | 40 | 40 | 40 | 50 | 50 | 50 |
| M* | 1 x M25 Cable Entry | | | 1 x M32 Cable Entry | | | 1 x M40 Cable Entry | | | 2 x M40 Cable Entry | | |
| Terminal Capacity | 1.5 – 2.5 sq. mm | | | 4 – 6 sq. mm | | | 10 – 16 sq. mm | | | 25 – 35 sq. mm | | |

Panel Mounted Plug IP67

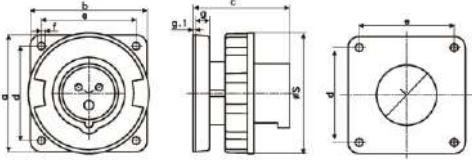

Surface Mounted Plug IP44

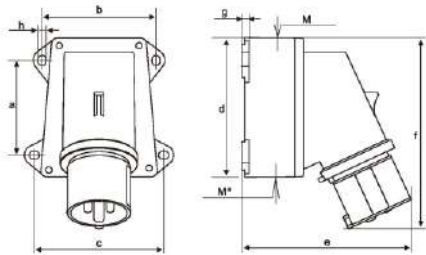

Surface Mounted Plug IP67

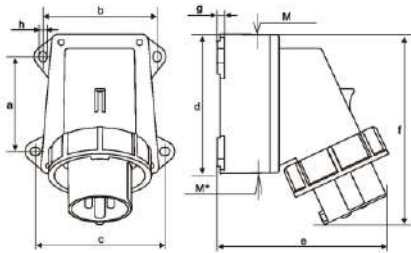

Surface Mounted Socket IP44

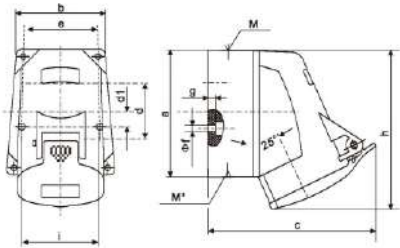

Surface Mounted Socket IP67

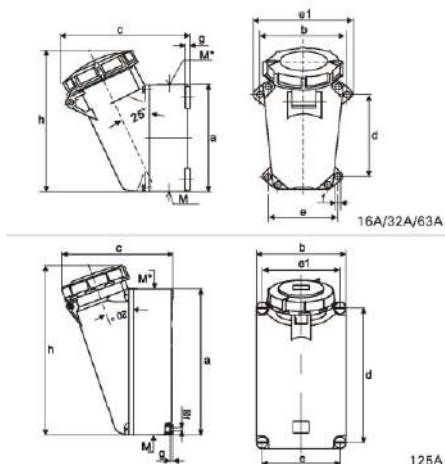

125A

All dimensions are in mm

Product Dimension Details

Panel Mounted Straight Socket IP44

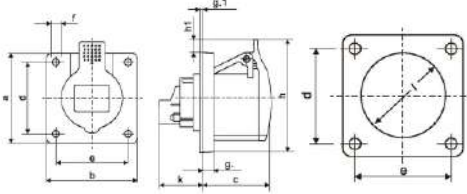

| Amp Pole | 16A | | | 32A | | | 63A | | | 125A | | |
|-------------------|------------------|------|------|--------------|-----|------|----------------|-----|-----|------|----|----|
| | 3P | 4P | 5P | 3P | 4P | 5P | 3P | 4P | 5P | 3P | 4P | 5P |
| a | 75 | 75 | 75 | 75 | 75 | 75 | 107 | 107 | 107 | | | |
| b | 75 | 75 | 75 | 75 | 75 | 75 | 100 | 100 | 100 | | | |
| c | 51 | 51.5 | 52 | 61 | 61 | 62 | 80 | 80 | 80 | | | |
| d | 60 | 60 | 60 | 60 | 60 | 60 | 85 | 85 | 85 | | | |
| e | 60 | 60 | 60 | 60 | 60 | 60 | 77 | 77 | 77 | | | |
| f | 5.5 | 5.5 | 5.5 | 5.5 | 5.5 | 5.5 | 6.5 | 6.5 | 6.5 | | | |
| g | 8 | 8 | 8 | 8 | 8 | 8 | 12 | 12 | 12 | | | |
| g.1 | 2 | 2 | 2 | 2 | 2 | 2 | 2 | 2 | 2 | | | |
| h | 84.6 | 90 | 94 | 96 | 96 | 102 | 113 | 113 | 113 | | | |
| h1 | 9.6 | 15 | 19.2 | 20 | 20 | 21.4 | 5.5 | 5.5 | 5.5 | | | |
| k | 33 | 33 | 34 | 41 | 41 | 41.5 | 55 | 55 | 55 | | | |
| l | 44 | 52 | 54.5 | 58 | 58 | 62 | 98 | 98 | 98 | | | |
| Terminal Capacity | 1.5 – 2.5 sq. mm | | | 4 – 6 sq. mm | | | 10 – 16 sq. mm | | | | | |

Panel Mounted Straight Socket IP67

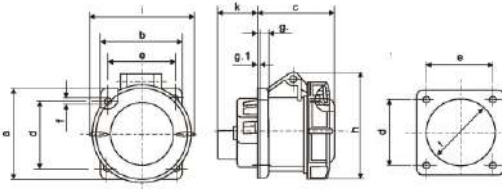

| | | | | | | | | | | | | |
|-------------------|------------------|-----|-----|--------------|-----|-----|----------------|-----|-----|----------------|------|------|
| a | 75 | 75 | 75 | 85 | 85 | 85 | 107 | 107 | 107 | 130 | 130 | 130 |
| b | 75 | 75 | 75 | 75 | 75 | 75 | 100 | 100 | 100 | 130 | 130 | 130 |
| c | 55 | 55 | 59 | 68 | 68 | 69 | 84 | 84 | 84 | 116 | 116 | 116 |
| d | 60 | 60 | 60 | 60 | 60 | 60 | 85 | 85 | 85 | 104 | 104 | 104 |
| e | 60 | 60 | 60 | 60 | 60 | 60 | 77 | 77 | 77 | 104 | 104 | 104 |
| f | 5.5 | 5.5 | 5.5 | 5.5 | 5.5 | 5.5 | 6.5 | 6.5 | 6.5 | 6.5 | 6.5 | 6.5 |
| g | 10 | 10 | 10 | 10 | 10 | 10 | 14 | 14 | 14 | 19.5 | 19.5 | 19.5 |
| g.1 | 2 | 2 | 2 | 2 | 2 | 2 | 2 | 2 | 2 | 2 | 2 | 2 |
| h | 83 | 83 | 85 | 99 | 99 | 105 | 113 | 113 | 113 | 128 | 128 | 128 |
| i | 78 | 85 | 93 | 103 | 103 | 110 | 118 | 118 | 118 | 135 | 135 | 135 |
| k | 30 | 31 | 32 | 40 | 40 | 41 | 55 | 55 | 55 | 43 | 43 | 43 |
| l | 44 | 54 | 55 | 60 | 60 | 62 | 88 | 88 | 88 | 105 | 105 | 105 |
| Terminal Capacity | 1.5 – 2.5 sq. mm | | | 4 – 6 sq. mm | | | 10 – 16 sq. mm | | | 25 – 35 sq. mm | | |

Panel Mounted Angled Socket IP44

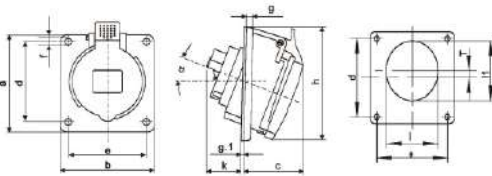

| | | | | | | | | | | | | |
|-------------------|------------------|-----|-----|--------------|-----|-----|----------------|------|------|--|--|--|
| a | 73.5 | 100 | 100 | 100 | 100 | 100 | 110 | 110 | 110 | | | |
| b | 64 | 92 | 92 | 92 | 92 | 92 | 106 | 106 | 106 | | | |
| c | 52 | 58 | 58 | 59 | 59 | 60 | 67.5 | 67.5 | 67.5 | | | |
| d | 60 | 85 | 85 | 85 | 85 | 85 | 85 | 85 | 85 | | | |
| e | 52 | 77 | 77 | 77 | 77 | 77 | 77 | 77 | 77 | | | |
| f | 5.3 | 5.3 | 5.3 | 5.5 | 5.5 | 5.5 | 6.5 | 6.5 | 6.5 | | | |
| g | 7 | 8 | 8 | 8 | 8 | 8 | 12 | 12 | 12 | | | |
| g.1 / T | 2 | 2 | 2 | 2 | 2 | 2 | 2/3 | 2/3 | 2/3 | | | |
| h | 79 | 105 | 108 | 107 | 107 | 112 | 134 | 134 | 134 | | | |
| k | 46 | 32 | 33 | 55 | 55 | 48 | 62 | 62 | 62 | | | |
| l | 55 | 70 | 70 | 73 | 73 | 76 | 90 | 90 | 90 | | | |
| l1 | 65 | 80 | 80 | 85 | 85 | 88 | 99 | 99 | 99 | | | |
| alpha | 20 | 20 | 20 | 20 | 20 | 20 | 20 | 20 | 20 | | | |
| Terminal Capacity | 1.5 – 2.5 sq. mm | | | 4 – 6 sq. mm | | | 10 – 16 sq. mm | | | | | |

Panel Mounted Angled Socket IP67

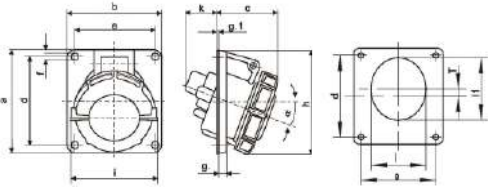

| | | | | | | | | | | | | |
|-------------------|------------------|-----|-----|--------------|-----|-----|----------------|-----|-----|----------------|-----|-----|
| a | 73.5 | 100 | 100 | 100 | 100 | 100 | 110 | 110 | 110 | 114 | 114 | 114 |
| b | 64 | 92 | 92 | 92 | 92 | 92 | 106 | 106 | 106 | 110 | 110 | 110 |
| c | 52 | 59 | 62 | 64 | 64 | 66 | 83 | 83 | 83 | 75 | 75 | 75 |
| d | 60 | 85 | 85 | 85 | 85 | 85 | 85 | 85 | 85 | 90 | 90 | 90 |
| e | 52 | 77 | 77 | 77 | 77 | 77 | 77 | 77 | 77 | 90 | 90 | 90 |
| f | 5.3 | 5.3 | 5.3 | 5.5 | 5.5 | 5.5 | 6.5 | 6.5 | 6.5 | 6.2 | 6.2 | 6.2 |
| g | 7 | 8 | 8 | 8 | 8 | 8 | 12 | 12 | 12 | 13 | 13 | 13 |
| g.1 | 2 | 2 | 2 | 2 | 2 | 2 | 2 | 2 | 2 | 2 | 2 | 2 |
| h | 84 | 103 | 105 | 109 | 109 | 113 | 115 | 115 | 115 | 125 | 125 | 125 |
| i | 78 | 85 | 96 | 103 | 103 | 110 | 117 | 117 | 117 | 135 | 135 | 135 |
| k | 48 | 32 | 33 | 55 | 55 | 48 | 62 | 62 | 62 | 98 | 98 | 98 |
| l | 55 | 70 | 70 | 73 | 73 | 76 | 90 | 90 | 90 | 100 | 100 | 100 |
| l1 | 65 | 80 | 80 | 85 | 85 | 88 | 99 | 99 | 99 | 107 | 107 | 107 |
| T | - | - | - | - | - | - | 3 | 3 | 3 | - | - | - |
| alpha | 20 | 20 | 20 | 20 | 20 | 20 | 20 | 20 | 20 | 15 | 15 | 15 |
| Terminal Capacity | 1.5 – 2.5 sq. mm | | | 4 – 6 sq. mm | | | 10 – 16 sq. mm | | | 25 – 35 sq. mm | | |

Product Dimension Details

Socket Outlet with Switches and Mechanical Interlock IP44

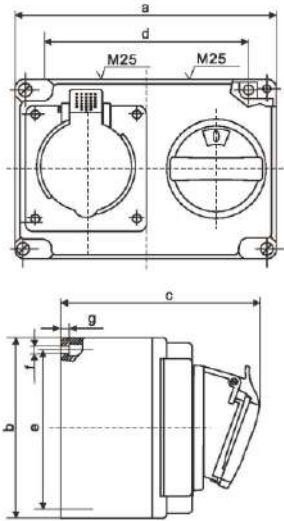

| Amp | 16A | | |
|-------------------|----------------|-----|-----|
| Pole | 3P | 4P | 5P |
| a | 170 | 170 | 170 |
| b | 118 | 118 | 118 |
| c | 134 | 137 | 141 |
| d | 136 | 136 | 136 |
| e | 104 | 104 | 104 |
| f | 6.1 | 6.1 | 6.1 |
| g | 2.5 | 2.5 | 2.5 |
| M | 25 | 25 | 25 |
| Terminal Capacity | 1.5- 2.5 sq.mm | | |

Socket Outlet with Switches and Mechanical Interlock IP67

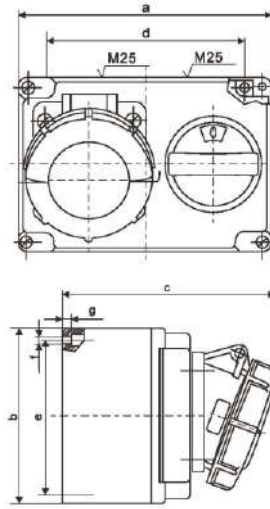

| Amp | 16A | | |
|-------------------|----------------|-----|-----|
| Pole | 3P | 4P | 5P |
| a | 170 | 170 | 170 |
| b | 118 | 118 | 118 |
| c | 136 | 139 | 143 |
| d | 136 | 136 | 136 |
| e | 104 | 104 | 104 |
| f | 6.1 | 6.1 | 6.1 |
| g | 2.5 | 2.5 | 2.5 |
| M | 25 | 25 | 25 |
| Terminal Capacity | 1.5- 2.5 sq.mm | | |

Socket Outlet with Switches and Mechanical Interlock Vertical IP44

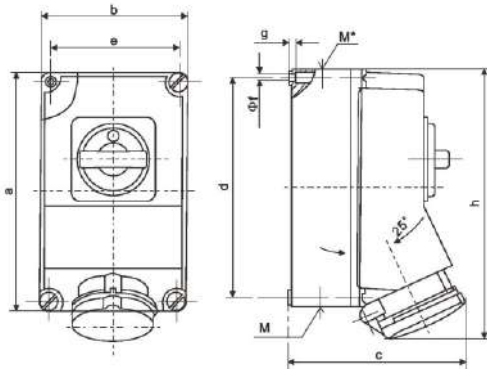

| Amp | 16A | | | 32A | | | 63A | | |
|-------------------|------------------|-------|-------|--------------|-------|-------|----------------|------|------|
| Pole | 3P | 4P | 5P | 3P | 4P | 5P | 3P | 4P | 5P |
| a | 225 | 225 | 225 | 225 | 225 | 225 | 262 | 262 | 262 |
| B | 118 | 118 | 118 | 118 | 118 | 118 | 162 | 162 | 162 |
| C | 139 | 141 | 143 | 144 | 144 | 148 | 192 | 192 | 192 |
| d | 208 | 208 | 208 | 208 | 208 | 208 | 240 | 240 | 240 |
| e | 101 | 101 | 101 | 101 | 101 | 101 | 140 | 140 | 140 |
| f | 6.3 | 6.3 | 6.3 | 6.3 | 6.3 | 6.3 | 8.1 | 8.1 | 8.1 |
| g | 8 | 8 | 8 | 8 | 8 | 8 | 8.3 | 8.3 | 8.3 |
| h | 250 | 252 | 254 | 264 | 264 | 268 | 300 | 300 | 300 |
| M | 2x25 | 2x25 | 2x25 | 2x25 | 2x25 | 2x25 | 2x40 | 2x40 | 2x40 |
| M* | 25/32 | 25/32 | 25/32 | 25/32 | 25/32 | 25/32 | 40 | 40 | 40 |
| Terminal Capacity | 1.5 – 2.5 sq. mm | | | 4 – 6 sq. mm | | | 10 – 16 sq. mm | | |

Socket Outlet with Switches and Mechanical Interlock Vertical IP67

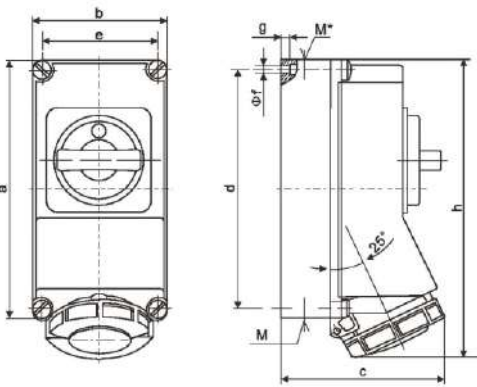

| Amp | 16A | | | 32A | | | 63A | | |
|-------------------|------------------|-------|-------|--------------|-------|-------|----------------|------|------|
| Pole | 3P | 4P | 5P | 3P | 4P | 5P | 3P | 4P | 5P |
| a | 225 | 225 | 225 | 225 | 225 | 225 | 262 | 262 | 262 |
| b | 118 | 118 | 118 | 118 | 118 | 118 | 162 | 162 | 162 |
| c | 144 | 146 | 147 | 152 | 152 | 153 | 196 | 196 | 196 |
| d | 208 | 208 | 208 | 208 | 208 | 208 | 240 | 240 | 240 |
| e | 101 | 101 | 101 | 101 | 101 | 101 | 140 | 140 | 140 |
| f | 6.3 | 6.3 | 6.3 | 6.3 | 6.3 | 6.3 | 8.1 | 8.1 | 8.1 |
| g | 8 | 8 | 8 | 8 | 8 | 8 | 8 | 8 | 8 |
| h | 252 | 255 | 259 | 268 | 268 | 274 | 300 | 300 | 300 |
| M | 2x25 | 2x25 | 2x25 | 2x25 | 2x25 | 2x25 | 2x40 | 2x40 | 2x40 |
| M* | 25/32 | 25/32 | 25/32 | 25/32 | 25/32 | 25/32 | 40 | 40 | 40 |
| Terminal Capacity | 1.5 – 2.5 sq. mm | | | 4 – 6 sq. mm | | | 10 – 16 sq. mm | | |

Product Dimension Details

Socket Outlet with Switches and Mechanical Interlock
Din Rail IP44

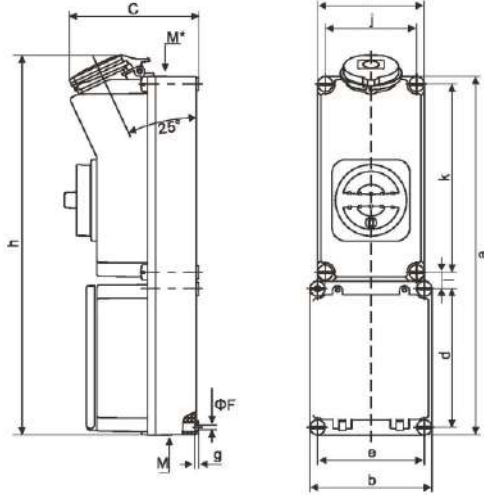

| Amp | 16A | | | 32A | | | 63A | | |
|-------------------|------------------|-------|-------|--------------|-------|-------|----------------|-------|-------|
| | 3P | 4P | 5P | 3P | 4P | 5P | 3P | 4P | 5P |
| Pole | 3P | 4P | 5P | 3P | 4P | 5P | 3P | 4P | 5P |
| a | 392.2 | 392.2 | 392.2 | 392.2 | 392.2 | 392.2 | 430 | 430 | 430 |
| b | 135 | 135 | 135 | 135 | 135 | 135 | 135 | 135 | 135 |
| c | 147 | 149 | 151 | 152 | 152 | 153 | 192 | 192 | 192 |
| d | 153.1 | 153.1 | 153.1 | 153.1 | 153.1 | 153.1 | 153 | 153 | 153 |
| e | 118 | 118 | 118 | 118 | 118 | 118 | 118 | 118 | 118 |
| f | 6.3 | 6.3 | 6.3 | 6.3 | 6.3 | 6.3 | 6.3 | 6.3 | 6.3 |
| g | 7 | 7 | 7 | 7 | 7 | 7 | 7 | 7 | 7 |
| h | 423 | 425 | 427 | 434 | 434 | 440 | 470 | 470 | 470 |
| i | 118 | 118 | 118 | 118 | 118 | 118 | 160 | 160 | 160 |
| j | 101 | 101 | 101 | 101 | 101 | 101 | 140 | 140 | 140 |
| k | 208 | 208 | 208 | 208 | 208 | 208 | 240 | 240 | 240 |
| l | 18.1 | 18.1 | 18.1 | 18.1 | 18.1 | 18.1 | 18.6 | 18.6 | 18.6 |
| M* | 2x25 | 2x25 | 2x25 | 2x25 | 2x25 | 2x25 | 1xM40 | 1xM40 | 1xM40 |
| M | 25/32 | 25/32 | 25/32 | 25/32 | 25/32 | 25/32 | 1xM32 1xM40 | | |
| Terminal Capacity | 1.5 – 2.5 sq. mm | | | 4 – 6 sq. mm | | | 10 – 16 sq. mm | | |

Socket Outlet with Switches and Mechanical Interlock
Din Rail IP67

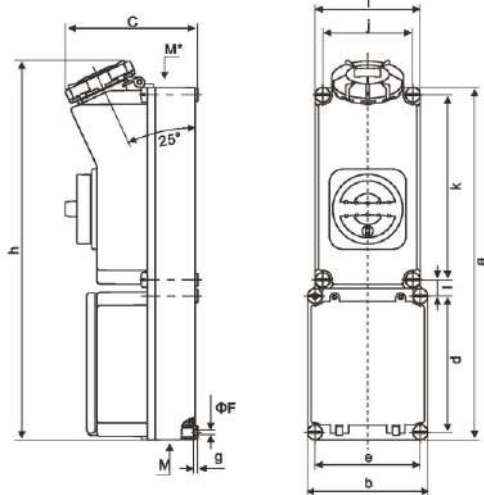

| Amp | 16A | | | 32A | | | 63A | | |
|-------------------|------------------|-------|-------|--------------|-------|-------|----------------|-------|-------|
| | 3P | 4P | 5P | 3P | 4P | 5P | 3P | 4P | 5P |
| Pole | 3P | 4P | 5P | 3P | 4P | 5P | 3P | 4P | 5P |
| a | 392.2 | 392.2 | 392.2 | 392.2 | 392.2 | 392.2 | 430 | 430 | 430 |
| b | 135 | 135 | 135 | 135 | 135 | 135 | 135 | 135 | 135 |
| c | 150 | 153 | 156 | 161 | 161 | 165 | 198 | 198 | 198 |
| d | 153.1 | 153.1 | 153.1 | 153.1 | 153.1 | 153.1 | 153 | 153 | 153 |
| e | 118 | 118 | 118 | 118 | 118 | 118 | 118 | 118 | 118 |
| f | 6.3 | 6.3 | 6.3 | 6.3 | 6.3 | 6.3 | 6.3 | 6.3 | 6.3 |
| g | 7 | 7 | 7 | 7 | 7 | 7 | 7 | 7 | 7 |
| h | 425 | 427 | 429 | 438 | 438 | 443 | 472 | 472 | 472 |
| i | 118 | 118 | 118 | 118 | 118 | 118 | 160 | 160 | 160 |
| j | 101 | 101 | 101 | 101 | 101 | 101 | 140 | 140 | 140 |
| k | 208 | 208 | 208 | 208 | 208 | 208 | 240 | 240 | 240 |
| l | 18.1 | 18.1 | 18.1 | 18.1 | 18.1 | 18.1 | 18.6 | 18.6 | 18.6 |
| M* | 2x25 | 2x25 | 2x25 | 2x25 | 2x25 | 2x25 | 1xM40 | 1xM40 | 1xM40 |
| M | 25/32 | 25/32 | 25/32 | 25/32 | 25/32 | 25/32 | 1xM32 1xM40 | | |
| Terminal Capacity | 1.5 – 2.5 sq. mm | | | 4 – 6 sq. mm | | | 10 – 16 sq. mm | | |

Socket Outlet with Switches and Mechanical Interlock
Vertical IP67

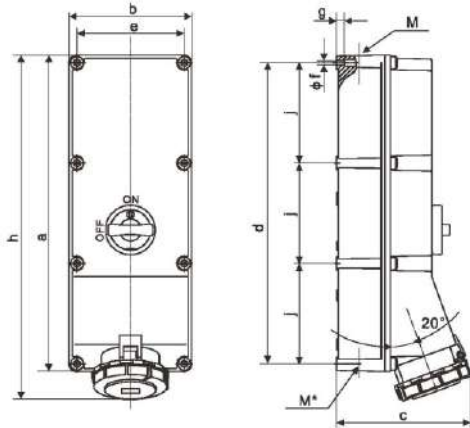

| Amp | 125A (Without DIN Rail) | | | Amp | 125A (DIN Type) | | |
|-------------------|-------------------------|------|------|-------------------|-----------------|------|------|
| | 3P | 4P | 5P | | 3P | 4P | 5P |
| Pole | 3P | 4P | 5P | Pole | 3P | 4P | 5P |
| a | 501 | 501 | 501 | a | 501 | 501 | 501 |
| b | 194 | 194 | 194 | b | 194 | 194 | 194 |
| c | 213 | 213 | 213 | c | 213 | 213 | 213 |
| d | 477 | 477 | 477 | d | 477 | 477 | 477 |
| e | 170 | 170 | 170 | e | 170 | 170 | 170 |
| f | 6.3 | 6.3 | 6.3 | f | 6.3 | 6.3 | 6.3 |
| g | 13.5 | 13.5 | 13.5 | g | 13.5 | 13.5 | 13.5 |
| h | 550 | 550 | 550 | h | 550 | 550 | 550 |
| J | 159 | 159 | 159 | J | 159 | 159 | 159 |
| M | 1xM40 + 1xM50 | | | M | 1xM40 + 1xM50 | | |
| M* | 1xM40 + 1xM50 | | | M* | 1xM40 + 1xM50 | | |
| Terminal Capacity | 25 – 35 sq. mm | | | Terminal Capacity | 25 – 35 sq. mm | | |

All dimensions are in mm

Industrial Core Product Range

- DC Contactors
- Limit Switches
- BSG Foot Switches
- Heavy Duty Foot Switches
- AC Solenoid & Brakes
- DC Brakes
- Polycarbonate Plug & Socket BPX Series
- Plugs & Sockets
- Plug & Socket Boxes
- Pneumatic Timers
- Punched Grid Resistors

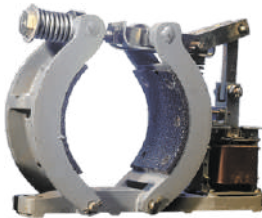
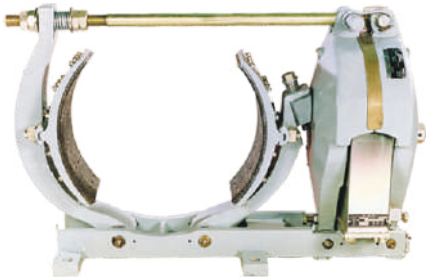

Notes

A series of horizontal dashed lines for writing notes.

- Power Control Products
- Starters & Submersible Pump Starters
- Industrial Enclosures
- Industrial Products
- Wires & Cables
- Motor Control Products
- Power Bus Duct
- Customised Solution
- Automation

a strong commitment to serve better always ...



BCH ELECTRIC LIMITED



www.bchindia.com



1800-103-9262

customercare@bchindia.com

Visit us at : www.bchindia.com

Registered & Corporate Office : 1105, New Delhi House, 27, Barakhamba Road, New Delhi - 110 001 Tel. : 91-11- 43673100

CIN : U31103DL1965PLC425953, **Customercare No.** 1800-103-9262, **E-mail :** marketing@bchindia.com

Works 1 : 20/4, Mathura Road, Faridabad - 121 006 (Haryana) Tel. : 0129-4063000/4293000 Fax : 0129-2304016

Works 2 : 64-68, Sector-7, IIE, Pant Nagar, Rudrapur, Udham Singh Nagar - 263 153 (Uttarakhand) Tel. : 05944-250214/16 Fax : 05944-250215

Sales Offices :

Ahmedabad
401, Shilp Zeveri,
Beside Shyamal Iconic,
Above Westside,
Shyamal Cross Road,
Ahmedabad - 380015
E-mail: ahmedabad@bchindia.com

Bangalore
2nd Floor, 130/5,
K.H. Road (Double road),
Bangalore - 560 027
Tel. : 080-41144879 / 22236759
E-mail : bangalore@bchindia.com

Bhubaneswar
Mallick Commercial
Complex Plot No.: A/69, unit - 3
Bhubaneswar - 751 001
Tel. : 0674-2380988
E-mail: bhubaneswar@bchindia.com

Chandigarh (Panchkula)
SCO -270, 2nd Floor,
Sector-16, Panchkula
Haryana-134 113
Tel. : 0172-5078957 / 5049905
E-mail: chandigarh@bchindia.com

Chennai
Flat No. 3A, 3rd Floor,
Sree Apartments,
No.508, TTK Road,
Alwarpet, Chennai 600 018
Tel. : 044-24337046, 24337047
E-mail : chennai@bchindia.com

Coimbatore
87, Dr. Nanjappa Road,
Coimbatore - 641 018
Tel. : 0422-2305311 / 2302599
E-mail : coimbatore@bchindia.com

Delhi 1
801, Akash Deep Building,
26A, Barakhamba Road,
New Delhi - 110 001
Tel. : 011-23313878 / 43518200
E-mail : delhi@bchindia.com

Delhi 2
710, Deepal Building, 92
Nehru Place, New Delhi - 110
019 Tel. : 011-45720334
E-mail : delhi2@bchindia.com

Dehradun
8, Co-operative Industrial Estate,
Patel Nagar, Dehradun-248001
E-mail : dehradun@bchindia.com

Faridabad
20/4, Mathura Road,
Faridabad - 121 006 (Haryana)
Tel. : 0129-4293009
E-mail : faridabad@bchindia.com

Hyderabad
1-8-303/48/13/102, Arya One,
2nd Floor, P. G. Road,
Secunderabad - 500 003
Tel. : 040-66206263/27890306
Fax : 040-66207273
E-mail : hyderabad@bchindia.com

Indore
330-331, Indraprastha Tower,
3rd Floor, 6, M.G. Road,
Indore - 452 001
Tel. : 0731-2510011 / 2510012
E-mail : indore@bchindia.com

Jaipur
25, Hathroi, Gopalbari,
Jaipur - 302 001
Tel. : 0141-2363521
E-mail : jaipur@bchindia.com

Jamshedpur
A.J. Tower, 2B,
2nd Floor, R-Road, Bistupur,
Jamshedpur - 831 001
E-mail : jamshedpur@bchindia.com

Kolkata
Block 1E, 216,
Acharya Jagadish Chandra Bose
Road, Kolkata - 700 017
Tel. : 033-22871728 / 46021884
E-mail : kolkata@bchindia.com

Lucknow
Shop No. 3, First Floor,
Tower T-10, Millennium Place IBB - 2,
Sushant Golf City, Sultanpur Road,
Lucknow U.P. - 226030
Tel. : 0522-4025597/4025997
E-mail : lucknow@bchindia.com

Ludhiana
S.C.O.- 18, 2nd Floor,
Feroze Gandhi Market,
Ludhiana - 140 001
Tel. : 0161-5021807/5022808
E-mail : ludhiana@bchindia.com

Madurai
12, Parvathi Plaza-3rd Floor,
70 Feet Road, Ellis Nagar
Madurai-625016, Tamilnadu
Email: madurai@bchindia.com

Mumbai
A-151, Mittal Tower,
Nariman Point,
Mumbai - 400 021
Tel. : 022-22822947/22850162
Fax : 022-22822858
E-mail : mumbai@bchindia.com

Patna
No.703, 7th Floor, Luv Kush
Tower, Exhibition Road,
Patna - 800001

Pune
8, Sarosh Bhavan,
16-B/1, Dr. Ambedkar Road,
Pune - 411 001
Tel. : 020-41210002
E-mail : pune@bchindia.com

Raipur
6th Floor, Office No. 607,
Babylon Capital, Near Oswal
Petrol Pump, VIP Chowk,
G.E. Road, Raipur - 492 006
Tel. : 0771- 4045053
E-mail : raipur@bchindia.com

Vadodara
301, Third Floor, "Florence Classic",
10, Ashapuri Co-Op. Hsg. Soc. Ltd., Opp. VUDA
Housing, Near Cow Circle, Akota, Vadodara - 390 020
Tel. : 0265-2345068/2345069
Telefax : 0265-2345068,
E-mail : vadodara@bchindia.com

Other Branch Locations

Cochin : cochin@bchindia.com, **Guwahati :** guwahati@bchindia.com, **Vishakapatnam :** vizag@bchindia.com, **Surat :** surat@bchindia.com, **Trichy :** Trichy@bchindia.com

Resident Engineer Locations

| | | | | | | | |
|------------|----------|-----------|------------|---------------|-------------|-------------|---------------|
| Agra | Bhopal | Hospet | Kanpur | Muzaffarnagar | Rajahmundry | Silliguri | Varanasi |
| Ahmednagar | Calicut | Hubli | Karimnagar | Nanded | Ranchi | Solapur | Vijaywada |
| Ambala | Goa | Idukki | Karnal | Nashik | Rourkela | Srinagar | Vishakapatnam |
| Anantapur | Gulbarga | Jabalpur | Kota | Panipat | Rudarpur | Trivendrum | Vellore |
| Ankleshwar | Gurgaon | Jalandhar | Kurmool | Patna | Salem | Tirunelveli | Vilupuram |
| Aurangabad | Haridwar | Jodhpur | Midnapore | Puducherry | Sikar | Udaipur | Warangal |
| Bhiwadi | Hisar | Kashipur | Mahua | Rajkot | Silchar | Vapi | Yamunanagar |